



Leicester
Application for a premises licence
Licensing Act 2003

For help contact
licensing@leicester.gov.uk
Telephone: +44 116 454 3040

* required information

Section 1 of 21

You can save the form at any time and resume it later. You do not need to be logged in when you resume.

System reference This is the unique reference for this application generated by the system.

Your reference You can put what you want here to help you track applications if you make lots of them. It is passed to the authority.

Are you an agent acting on behalf of the applicant?

☒ Yes ☐ No

Put "no" if you are applying on your own behalf or on behalf of a business you own or work for.

Applicant Details

* First name

* Family name

* E-mail

Main telephone number Include country code.

Other telephone number

☒ Indicate here if the applicant would prefer not to be contacted by telephone

Is the applicant:

- ☐ Applying as a business or organisation, including as a sole trader
☒ Applying as an individual

A sole trader is a business owned by one person without any special legal structure. Applying as an individual means the applicant is applying so the applicant can be employed, or for some other personal reason, such as following a hobby.

Continued from previous page...

Address

* Building number or name

* Street

District

* City or town

County or administrative area

* Postcode

* Country

Agent Details

* First name

ANIL

* Family name

BHAWSAR

* E-mail

Main telephone number

Other telephone number

Include country code.

☐ Indicate here if you would prefer not to be contacted by telephone

Are you:

- ☐ An agent that is a business or organisation, including a sole trader
- ☒ A private individual acting as an agent

A sole trader is a business owned by one person without any special legal structure.

Your Address

* Building number or name

* Street

District

* City or town

County or administrative area

* Postcode

* Country

Address official correspondence should be sent to.

Section 2 of 21

PREMISES DETAILS

Continued from previous page...

I/we, as named in section 1, apply for a premises licence under section 17 of the Licensing Act 2003 for the premises described in section 2 below (the premises) and I/we are making this application to you as the relevant licensing authority in accordance with section 12 of the Licensing Act 2003.

Premises Address

Are you able to provide a postal address, OS map reference or description of the premises?

☒ Address ☐ OS map reference ☐ Description

Postal Address Of Premises

Building number or name	DOSTI PAN CENTRE AND OFF LICENCE
Street	2C , UPPINGHAM ROAD
District	LEICESTER
City or town	
County or administrative area	
Postcode	LE5 0QD
Country	United Kingdom

Further Details

Telephone number	
Non-domestic rateable value of premises (£)	3,450

Section 3 of 21

APPLICATION DETAILS

In what capacity are you applying for the premises licence?

- ☒ An individual or individuals
- ☐ A limited company / limited liability partnership
- ☐ A partnership (other than limited liability)
- ☐ An unincorporated association
- ☐ Other (for example a statutory corporation)
- ☐ A recognised club
- ☐ A charity
- ☐ The proprietor of an educational establishment
- ☐ A health service body
- ☐ A person who is registered under part 2 of the Care Standards Act 2000 (c14) in respect of an independent hospital in Wales
- ☐ A person who is registered under Chapter 2 of Part 1 of the Health and Social Care Act 2008 in respect of the carrying on of a regulated activity (within the meaning of that Part) in an independent hospital in England
- ☐ The chief officer of police of a police force in England and Wales

Confirm The Following

- ☒ I am carrying on or proposing to carry on a business which involves the use of the premises for licensable activities
- ☐ I am making the application pursuant to a statutory function
- ☐ I am making the application pursuant to a function discharged by virtue of His Majesty's prerogative

Section 4 of 21

INDIVIDUAL APPLICANT DETAILS

Applicant Name

Is the name the same as (or similar to) the details given in section one?

- ☒ Yes ☐ No

If "Yes" is selected you can re-use the details from section one, or amend them as required. Select "No" to enter a completely new set of details.

First name

AJAY

Family name

VALGI

Is the applicant 18 years of age or older?

- ☒ Yes ☐ No

Continued from previous page...

Current Residential Address

Is the address the same as (or similar to) the address given in section one?

☒ Yes

☐ No

If "Yes" is selected you can re-use the details from section one, or amend them as required. Select "No" to enter a completely new set of details.

Building number or name

Street

District

City or town

County or administrative area

Postcode

Country

Applicant Contact Details

Are the contact details the same as (or similar to) those given in section one?

☒ Yes

☐ No

If "Yes" is selected you can re-use the details from section one, or amend them as required. Select "No" to enter a completely new set of details.

E-mail

Telephone number

Other telephone number

* Date of birth

* Nationality

Right to work share code

Documents that demonstrate entitlement to work in the UK
Right to work share code if not submitting scanned documents

Add another applicant

Section 5 of 21

OPERATING SCHEDULE

When do you want the premises licence to start?

/ /
dd mm yyyy

If you wish the licence to be valid only for a limited period, when do you want it to end

/ /
dd mm yyyy

Provide a general description of the premises

Continued from previous page...

For example the type of premises, its general situation and layout and any other information which could be relevant to the licensing objectives. Where your application includes off-supplies of alcohol and you intend to provide a place for consumption of these off-supplies you must include a description of where the place will be and its proximity to the premises.

A SMALL SHOP SITUATED ON A MAIN ROAD .TO RETAIL PAN ,SNACKS , CONFECTIONARY DRINKS ,ALCOHOL TOBACCO AND VAPES . TO OPEN 06:00 TO 00:00 . MONDAY TO SUNDAY.

If 5,000 or more people are expected to attend the premises at any one time, state the number expected to attend

Section 6 of 21

PROVISION OF PLAYS

[See guidance on regulated entertainment](#)

Will you be providing plays?

☐ Yes ☒ No

Section 7 of 21

PROVISION OF FILMS

[See guidance on regulated entertainment](#)

Will you be providing films?

☐ Yes ☒ No

Section 8 of 21

PROVISION OF INDOOR SPORTING EVENTS

[See guidance on regulated entertainment](#)

Will you be providing indoor sporting events?

☐ Yes ☒ No

Section 9 of 21

PROVISION OF BOXING OR WRESTLING ENTERTAINMENTS

[See guidance on regulated entertainment](#)

Will you be providing boxing or wrestling entertainments?

☐ Yes ☒ No

Section 10 of 21

PROVISION OF LIVE MUSIC

[See guidance on regulated entertainment](#)

Will you be providing live music?

☐ Yes ☒ No

Section 11 of 21

PROVISION OF RECORDED MUSIC

[See guidance on regulated entertainment](#)

Continued from previous page...

Will you be providing recorded music?

☐ Yes

☒ No

Section 12 of 21

PROVISION OF PERFORMANCES OF DANCE

[See guidance on regulated entertainment](#)

Will you be providing performances of dance?

☐ Yes

☒ No

Section 13 of 21

PROVISION OF ANYTHING OF A SIMILAR DESCRIPTION TO LIVE MUSIC, RECORDED MUSIC OR PERFORMANCES OF DANCE

[See guidance on regulated entertainment](#)

Will you be providing anything similar to live music, recorded music or performances of dance?

☐ Yes

☒ No

Section 14 of 21

LATE NIGHT REFRESHMENT

Will you be providing late night refreshment?

☐ Yes

☒ No

Section 15 of 21

SUPPLY OF ALCOHOL

Will you be selling or supplying alcohol?

☒ Yes

☐ No

Standard Days And Timings

MONDAY

Start

End

Start

End

TUESDAY

Start

End

Start

End

WEDNESDAY

Start

End

Start

End

THURSDAY

Start

End

Start

End

Give timings in 24 hour clock.
(e.g., 16:00) and only give details for the days
of the week when you intend the premises
to be used for the activity.

Continued from previous page...

FRIDAY

Start 06:00

End 00:00

Start

End

SATURDAY

Start 06:00

End 00:00

Start

End

SUNDAY

Start 06:00

End 00:00

Start

End

Will the sale of alcohol be for consumption:

☐ On the premises ☒ Off the premises ☐ Both

If the sale of alcohol is for consumption on the premises select on, if the sale of alcohol is for consumption away from the premises select off. If the sale of alcohol is for consumption on the premises and away from the premises select both.

State any seasonal variations

For example (but not exclusively) where the activity will occur on additional days during the summer months.

Non-standard timings. Where the premises will be used for the supply of alcohol at different times from those listed in the column on the left, list below

For example (but not exclusively), where you wish the activity to go on longer on a particular day e.g. Christmas Eve.

State the name and details of the individual whom you wish to specify on the licence as premises supervisor

Name

First name

AJAY

Family name

VALGI

Date of birth

dd mm yyyy

Continued from previous page...

Enter the contact's address

Building number or name

Street

District

City or town

County or administrative area

Postcode

Country

Personal Licence number
(if known)

Issuing licensing authority
(if known)



PROPOSED DESIGNATED PREMISES SUPERVISOR CONSENT

How will the consent form of the proposed designated premises supervisor be supplied to the authority?

- ☐ Electronically, by the proposed designated premises supervisor
- ☒ As an attachment to this application

Reference number for consent form (if known)

If the consent form is already submitted, ask the proposed designated premises supervisor for its 'system reference' or 'your reference'.

Section 16 of 21

ADULT ENTERTAINMENT

Highlight any adult entertainment or services, activities, or other entertainment or matters ancillary to the use of the premises that may give rise to concern in respect of children

Give information about anything intended to occur at the premises or ancillary to the use of the premises which may give rise to concern in respect of children, regardless of whether you intend children to have access to the premises, for example (but not exclusively) nudity or semi-nudity, films for restricted age groups etc gambling machines etc.

NONE

Section 17 of 21

HOURS PREMISES ARE OPEN TO THE PUBLIC

Standard Days And Timings

MONDAY

Start

End

Start

End

Give timings in 24 hour clock.
(e.g., 16:00) and only give details for the days of the week when you intend the premises to be used for the activity.

Continued from previous page...

TUESDAY

Start	<input type="text" value="06:00"/>	End	<input type="text" value="00:00"/>
Start	<input type="text"/>	End	<input type="text"/>

WEDNESDAY

Start	<input type="text" value="06:00"/>	End	<input type="text" value="00:00"/>
Start	<input type="text"/>	End	<input type="text"/>

THURSDAY

Start	<input type="text" value="06:00"/>	End	<input type="text" value="00:00"/>
Start	<input type="text"/>	End	<input type="text"/>

FRIDAY

Start	<input type="text" value="06:00"/>	End	<input type="text" value="00:00"/>
Start	<input type="text"/>	End	<input type="text"/>

SATURDAY

Start	<input type="text" value="06:00"/>	End	<input type="text" value="00:00"/>
Start	<input type="text"/>	End	<input type="text"/>

SUNDAY

Start	<input type="text" value="06:00"/>	End	<input type="text" value="00:00"/>
Start	<input type="text"/>	End	<input type="text"/>

State any seasonal variations

For example (but not exclusively) where the activity will occur on additional days during the summer months.

Non standard timings. Where you intend to use the premises to be open to the members and guests at different times from those listed in the column on the left, list below

For example (but not exclusively), where you wish the activity to go on longer on a particular day e.g. Christmas Eve.

Section 18 of 21

LICENSING OBJECTIVES

Describe the steps you intend to take to promote the four licensing objectives:

a) General – all four licensing objectives (b,c,d,e)

Continued from previous page...

List here steps you will take to promote all four licensing objectives together.

ALL DUTIES WILL BE CONDUCTED IN A MANNER SUITABLE NOT TO UNDERMINE THE OBJECTIVES OF THE LICENCE ACT 2003.

ALL STAFF EMPLOYED WILL GO THROUGH IN HOUSE ALCOHOL RETAIL TRAINING

b) The prevention of crime and disorder

The licence holder will ensure a high definition, colour HD CCTV camera system is installed, operational and recording whilst the premises is open to the public. The system must permit the identification of individual(s) in all lighting conditions.

CCTV cameras must cover all areas that the public have access to, including the entrance, exit and pavement area immediately outside the premises.

CCTV system images must be securely stored, display an accurate date/time stamp and retained for a minimum of 31 days.

The licence holder will ensure that there is always a member of staff trained and available to download images/ footage immediately or an agreed timescale if requested by the police or the Licensing Authority.

The licence holder shall take reasonable steps to prevent public nuisance being caused by customers outside the premises by displaying prominent Quiet notices requesting customers respect the needs of local residents.

A Challenge 25 policy will be adopted with the only acceptable proof of age identification consisting of a current passport, photo card driving licence or identification carrying a PASS logo. A training record must be kept on the premises, retained for 12 months from the date of the incident and produced to an officer from a responsible authority upon request.

c) Public safety

The premises will be kept clean and clear of obstruction for customers.

CCTV operate throughout opening hours.

d) The prevention of public nuisance

Posters will be placed at entrance door and walls within the premises. The poster will inform customers the importance to leave quietly in the late hours of the evening and to observe noise levels.

e) The protection of children from harm

CCTV system installed inside & outside.

Acceptance of accredited 'Proof of age' cards and / or passport, or driving Licence with photograph.

Training of staff to be aware of underage purchasing

Challenge 25 posters will be displayed. 'No proper ID No Sale' policy.

Maintain a refusals book. Kept behind the counter

Section 19 of 21

NOTES ON DEMONSTRATING ENTITLEMENT TO WORK IN THE UK

Continued from previous page...

- Dance: no licence is required for performances between 08.00 and 23.00 on any day, provided that the audience does not exceed 500. However, a performance which amounts to adult entertainment remains licensable.
- Cross activity exemptions: no licence is required between 08.00 and 23.00 on any day, with no limit on audience size for:
 - o any entertainment taking place on the premises of the local authority where the entertainment is provided by or on behalf of the local authority;
 - o any entertainment taking place on the hospital premises of the health care provider where the entertainment is provided by or on behalf of the health care provider;
 - o any entertainment taking place on the premises of the school where the entertainment is provided by or on behalf of the school proprietor; and
 - o any entertainment (excluding films and a boxing or wrestling entertainment) taking place at a travelling circus, provided that (a) it takes place within a moveable structure that accommodates the audience, and (b) that the travelling circus has not been located on the same site for more than 28 consecutive days.

Section 21 of 21

PAYMENT DETAILS

This fee must be paid to the authority. If you complete the application online, you must pay it by debit or credit card.

Fees are dependent on the business rate band of the premises. Further information is provided at the link below: <https://www.leicester.gov.uk/business/licences-and-permits/entertainment-food-and-drink-licensing/beer-entertainment-and-late-night-refreshment/policy-and-guidance/>

* Fee amount (£)

100.00

DECLARATION

[Applicable to individual applicants only, including those in a partnership which is not a limited liability partnership] I understand I am not entitled to be issued with a licence if I do not have the entitlement to live and work in the UK (or if I am subject to a condition preventing me from doing work relating to the carrying on of a licensable activity) and that my licence will become invalid if I cease to be entitled to live and work in the UK (please read guidance note 15).

The DPS named in this application form is entitled to work in the UK (and is not subject to conditions preventing him or her from doing work relating to a licensable activity) and I have seen a copy of his or her proof of entitlement to work, if appropriate (please see note 15)

☒ Ticking this box indicates you have read and understood the above declaration

This section should be completed by the applicant, unless you answered "Yes" to the question "Are you an agent acting on behalf of the applicant?"

* Full name

ANIL BHAWSAR

* Capacity

LICENSING AGENTS C/O LICENSING HUB

* Date

03 / 03 / 2025
dd mm yyyy

Add another signatory

Once you're finished you need to do the following:

1. Save this form to your computer by clicking file/save as...

2. Go back to <https://www.gov.uk/apply-for-a-licence/premises-licence/leicester/apply-1> to upload this file and continue with your application.

Don't forget to make sure you have all your supporting documentation to hand.

Continued from previous page...

IT IS AN OFFENCE LIABLE TO SUMMARY CONVICTION TO A FINE OF ANY AMOUNT UNDER SECTION 158 OF THE LICENSING ACT 2003, TO MAKE A FALSE STATEMENT IN OR IN CONNECTION WITH THIS APPLICATION

IT IS AN OFFENCE UNDER SECTION 24B OF THE IMMIGRATION ACT 1971 FOR A PERSON TO WORK WHEN THEY KNOW, OR HAVE REASONABLE CAUSE TO BELIEVE, THAT THEY ARE DISQUALIFIED FROM DOING SO BY REASON OF THEIR IMMIGRATION STATUS. THOSE WHO EMPLOY AN ADULT WITHOUT LEAVE OR WHO IS SUBJECT TO CONDITIONS AS TO EMPLOYMENT WILL BE LIABLE TO A CIVIL PENALTY UNDER SECTION 15 OF THE IMMIGRATION, ASYLUM AND NATIONALITY ACT 2006 AND PURSUANT TO SECTION 21 OF THE SAME ACT, WILL BE COMMITTING AN OFFENCE WHERE THEY DO SO IN THE KNOWLEDGE, OR WITH REASONABLE CAUSE TO BELIEVE, THAT THE EMPLOYEE IS DISQUALIFIED

OFFICE USE ONLY



Applicant reference number	<input type="text" value="DOSTI PAN CENTRE AND OFF LICENCE"/>
Fee paid	<input type="text"/>
Payment provider reference	<input type="text"/>
ELMS Payment Reference	<input type="text"/>
Payment status	<input type="text"/>
Payment authorisation code	<input type="text"/>
Payment authorisation date	<input type="text"/>
Date and time submitted	<input type="text"/>
Approval deadline	<input type="text"/>
Error message	<input type="text"/>
Is Digitally signed	<input type="checkbox"/>

[1](#) [2](#) [3](#) [4](#) [5](#) [6](#) [7](#) [8](#) [9](#) [10](#) [11](#) [12](#) [13](#) [14](#) [15](#) [16](#) [17](#) [18](#) [19](#) [20](#) [21](#) [Next >](#)

DOSTI PAN CENTRE & OFF LICENCE

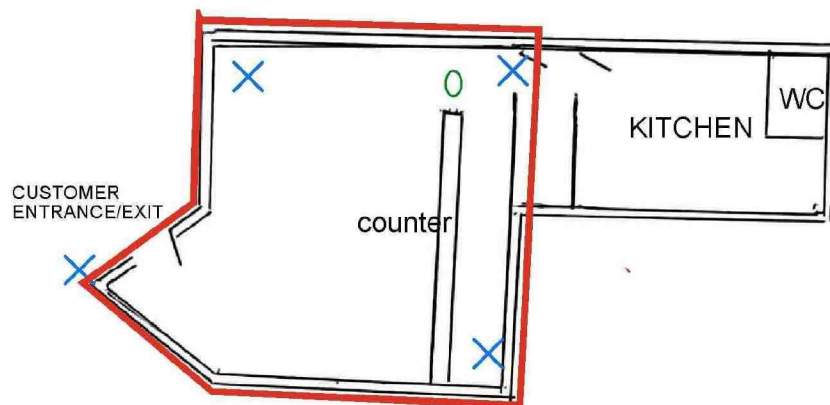
2C UPPINGHAM ROAD LEICESTER LE5 0QD



SCALE 1:100 1CM :1 METRE	
 LICENSABLE AREA	
 CCTV CAMERAS	
 FIRE EXTINGUISHER	
LICENSING HUB INFO@LICENSINGHUB.CO.UK 07766 275 750	DATE 03/03/2025

Licensing

- [Applications](#)
- [Help](#)

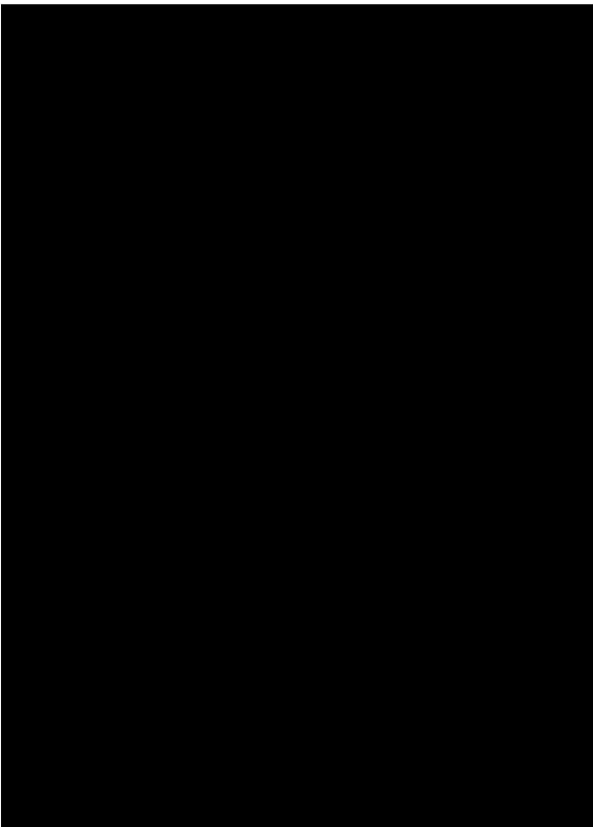

Total fee:
Variable
Payment status:
Paid

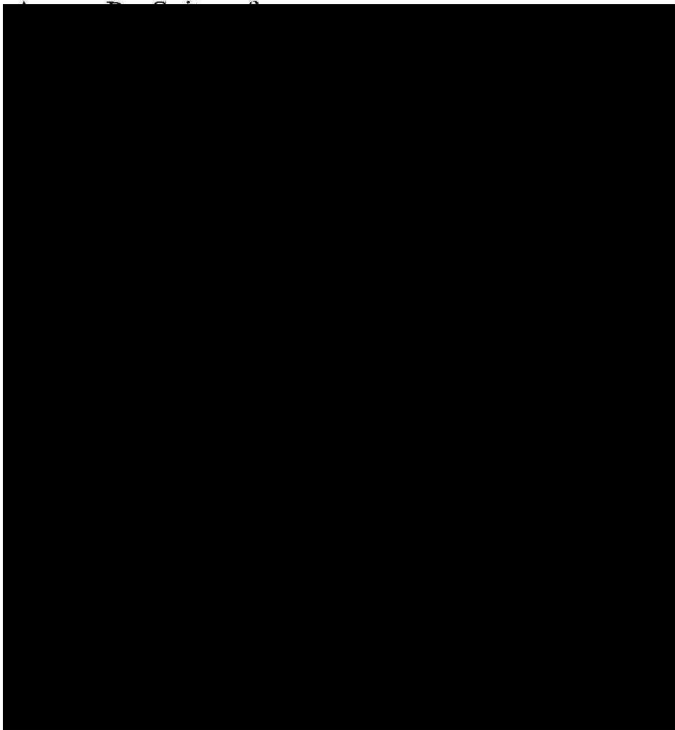

Consent of individual to being specified as premises supervisor

I AJAY VALGI
Of 
hereby
confirm that I give my consent to be specified as the designated premises supervisor in
relation to the application for
PREMISES LICENCE
Type of application
by
[name of AJAY VALGI
applicant]

relating to a premises licence N/A
[number of existing licence, if any]

for DOSTI PAN CENTRE & OFF LICENCE
2C UPPINGHAM ROAD, LEICESTER, LE5 0QD
[name and
address of
premises to which the application relate and any premises licence to be granted or varied in
respect of this application made by

AJAY VALGI
[name of applicant]

concerning the supply of alcohol at DOSTI PAN CENTRE & OFF LICENCE
2C UPPINGHAM ROAD, LEICESTER, LE5 0QD
[name and
address of
premises to
which application relates]

I also confirm that I am entitled to work in the United Kingdom and intend to apply for or
currently hold a personal licence, details of which I set out below.

Personal licence number
insert personal licence number, APPLYING TO COUNCIL

Personal licence issuing authority LEICESTER CITY COUNCIL

[insert name and address and telephone number of personal licence issuing authority, if any]

Signed 

Name (please print) AJAY VALGI

Date 04/03/2025